

DVA241.XXX vibration acceleration sensors with current output

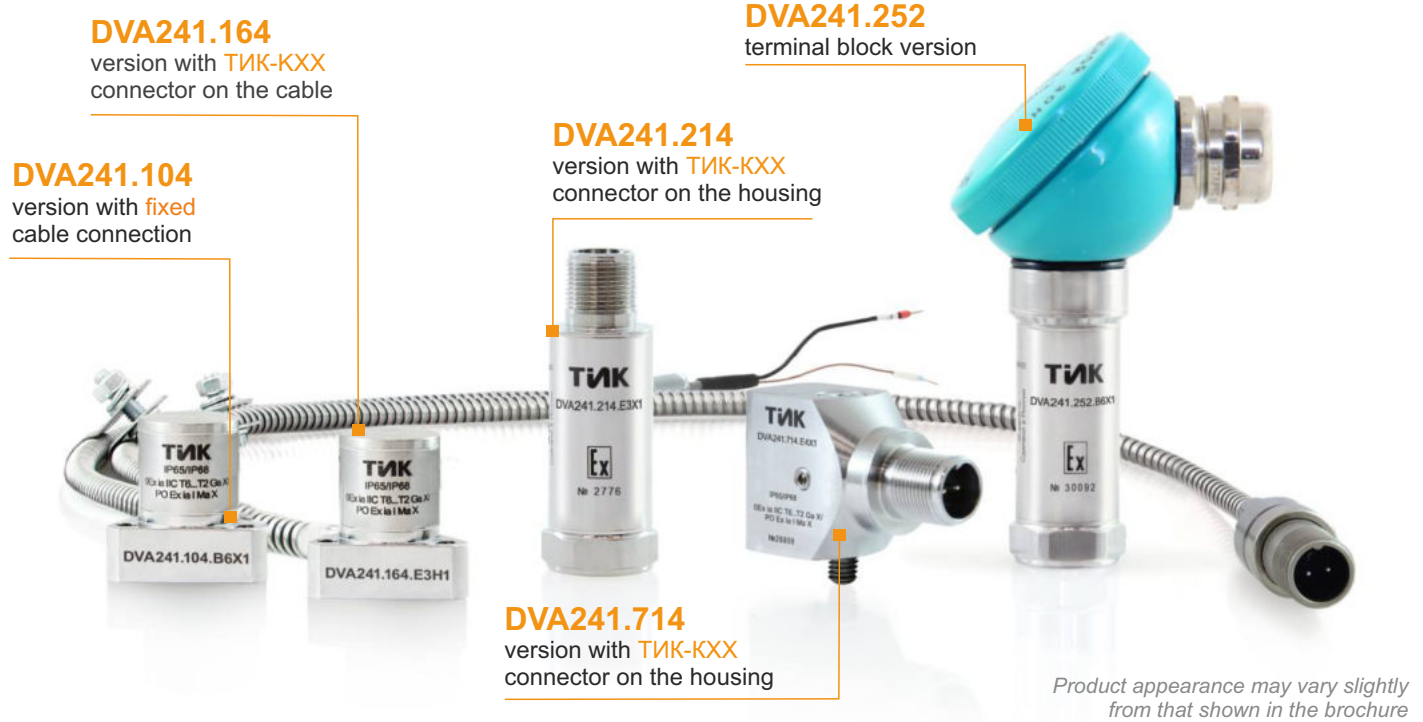

Features

Designed for measuring the RMS value of vibration acceleration in emergency protection systems (EPS). They consist of a hermetically sealed enclosure containing an integral acceleration sensor and a conversion board.

Depending on the version, the standard M8 stud, 3 screws or 1 screw is used for mounting on the unit. On special order, studs with other threads, including inch threads, are available.

The .214 version allows the use of cable assemblies with a MIL connector from imported transducers.

Metrological parameters

Conversion coefficient, mA*s ² /m		
0.64	0.4	0.16
Measurement ranges for the RMS value of vibration acceleration, m/s ² :		
0-25	0-40	0-100

Operating frequency range, Hz 2-1000;
3-1000;
5-1000;
10-1000

Climatic version

Operating temperature range, °C

- H climatic version -40...+80
- X climatic version -60...+80
- K climatic version -196...+80

Interface

Output signal type (4-20) mA
Sensor supply voltage, V 10-24
Connection via the TIK-PLC controller* or the TIK-BIS safety barrier

* The controller operates as EPS, sensor power source, and a safety barrier

Protection parameters

Explosion protection

- PO Ex ia I Ma X
0Ex ia IIC T₆₀...T₂ Ga X
Ex ia IIIC T₂₀₀ 100°C ... T₂₀₀ 280°C Da X
Ex ib IIIC T₉₅°C ... T₂₇₅°C Db X
- 2Ex nA IIC T₆₀...T₂ Gc X
- PO Ex ia I Ma X
- 0Ex ia IIC T₆₀...T₂ Ga X
- Ex ia IIIC T₂₀₀ 100°C ... T₂₀₀ 280°C Da X
- Ex ib IIIC T₉₅°C ... T₂₇₅°C Db X

Protection class

- IP65/68 (DVA241.104/164/214/714)
- IP65 (DVA241.252)

Reliability parameters

MTBF, hours, not less than 100 000
Warranty service life, months 24
Service life, years 20
Verification interval, years 2



Constructive versions

DVA241.104

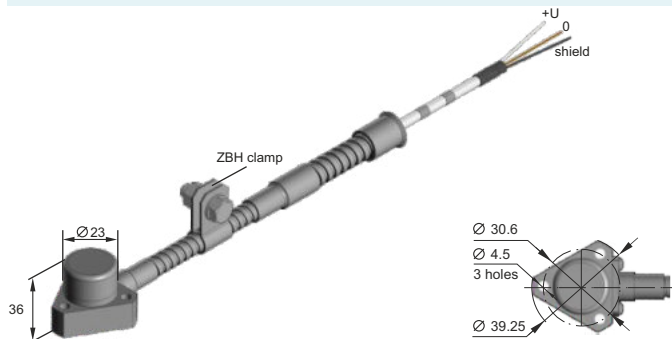

DVA241.164

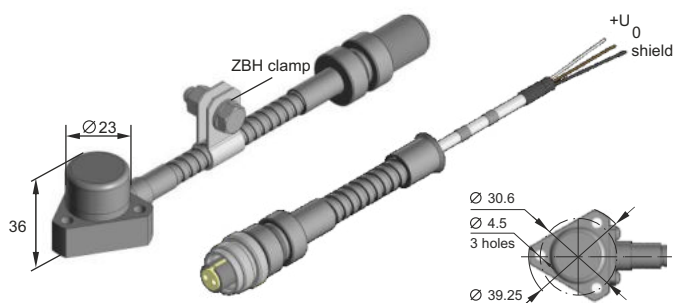

DVA241.214

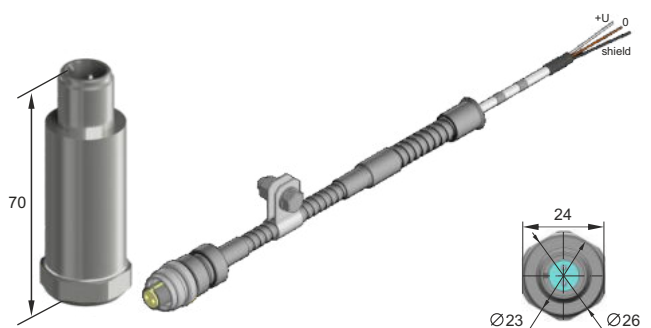

DVA241.252

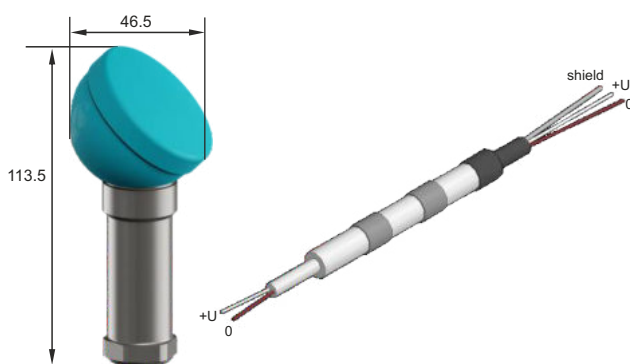

DVA241.714

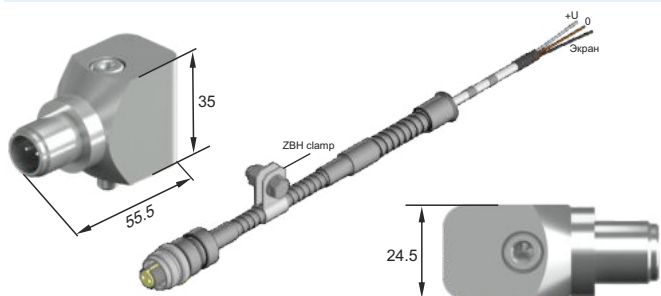

Wiring diagrams

